

GEWISS

elettricità amica

Serie 42 RV

IP 55 

Centralini stagni da parete e incasso per emergenza

Wall and flush mounted proofed emergency control boxes

Centrales étanches en saillie et à encastrer pour urgence

Centralitas herméticas de pared y empotradas para emergencia

Dichte Alarmzentralen für die Auf- und Unterputzinstallation

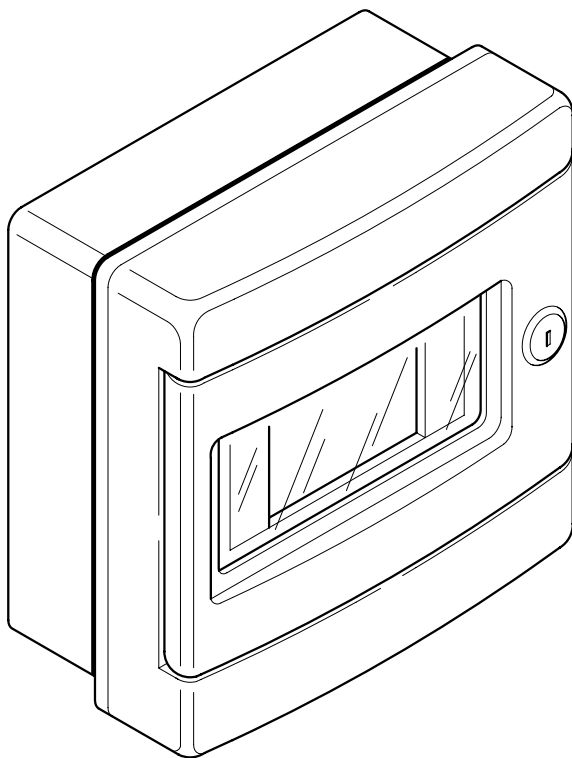

GEWISS SPA - PRODUZIONE MATERIALE ELETTRICO

I - 24069 Cenate Sotto - Via A. Volta, 1 (Bergamo) - Italia - Telefax +39 035 945222 - Telefono +39 035 946111

E-mail: gewiss@gewiss.com - <http://www.gewiss.com>

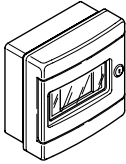

Con guida EN 50 022
 With EN 50 022 rail
 Avec rail EN 50 022
 Con carril EN 50 022
 Mit Schiene EN 50 022

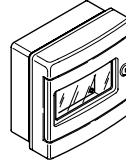
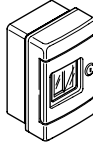

Con piastra di fondo
 With back plate
 Avec plaque de fond
 Con placa de fondo
 Mit Montageplatte

GW 42 202 8M **RAL3000**
 GW 42 208 8M **RAL7035**

GW 42 206 4M **RAL3000**
 GW 42 207 4M **RAL7035**

GW 42 203 8M **RAL3000**

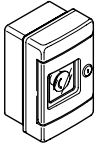

Per apparecchi \varnothing 22
 For \varnothing 22 equipment
 Pour des appareils de \varnothing 22
 Para aparatos \varnothing 22
 Für Geräte mit \varnothing 22



Ad incasso
 Flush-mounted
 Incasso
 Empotrada
 Für die Unterputzinstallation

GW 42 204 4M **RAL3000**

GW 42 231 4M **RAL3000**
 GW 42 232 4M **RAL7035**

GW 42 202
 GW 42 206
 GW 42 207
 GW 42 208

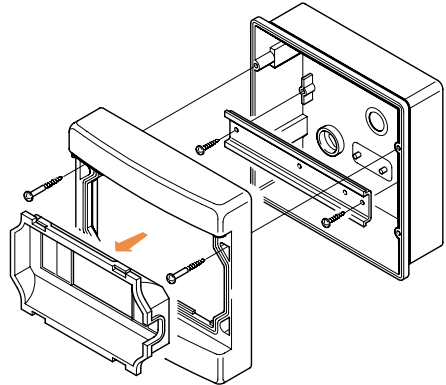
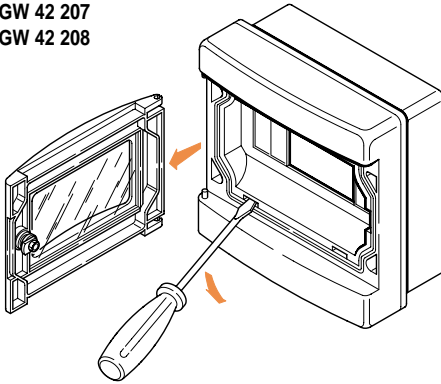

GW 42 203

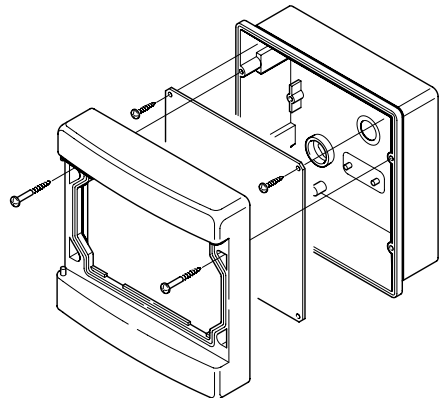
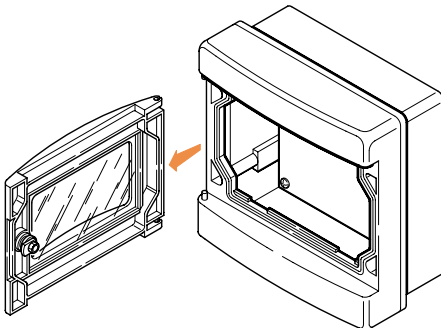



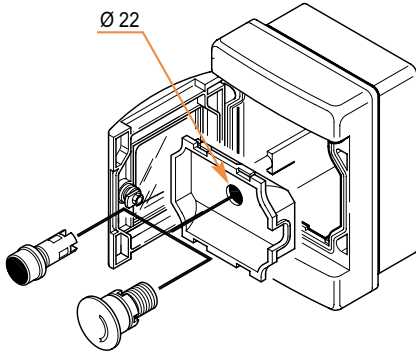

GW 42 204

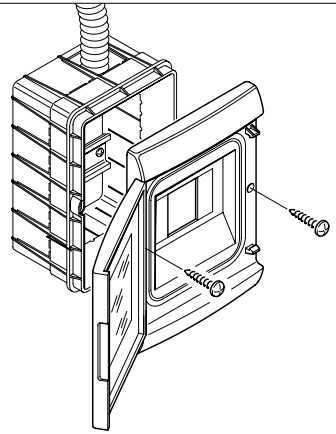

GW 42 231
GW 42 232

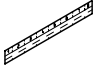

					
GW 42 202	3	1	1	1	1
GW 42 203	3	-	-	1	1
GW 42 204	2	-	-	1	1
GW 42 206	2	-	1	1	1
GW 42 207	2	-	1	1	1
GW 42 208	3	1	1	1	1
GW 42 231	-	-	1	1	1
GW 42 232	-	-	1	1	1

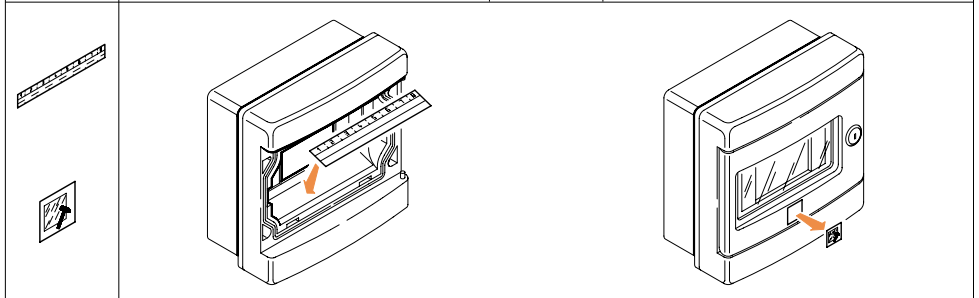
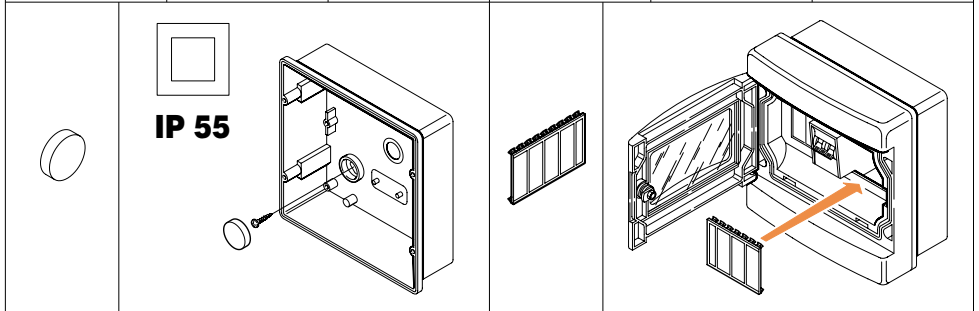

In caso di necessità rompere il vetro.
In case of emergency, break glass.
 En cas de besoin, briser le verre.
 En caso de necesidad, romper el cristal.
 Im Notfall Scheibe einschlagen.

Per la sostituzione del vetro procedere come indicato in figura.
To replace the glass, see instructions in figure.
 Pour remplacer le verre, suivre les indications de la figure.
 Para la sustitución del cristal, actuar como se indica en la figura.
 Der Ersatz der Scheibe ist, wie in der Abbildung gezeigt, vorzunehmen.

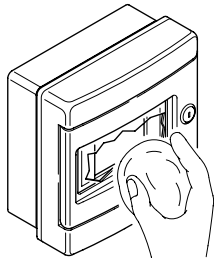

CRACK!

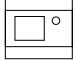
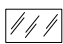
	
GW 42 204 GW 42 206 GW 42 207	GW 42 213
GW 42 202 GW 42 203 GW 42 208	GW 42 212

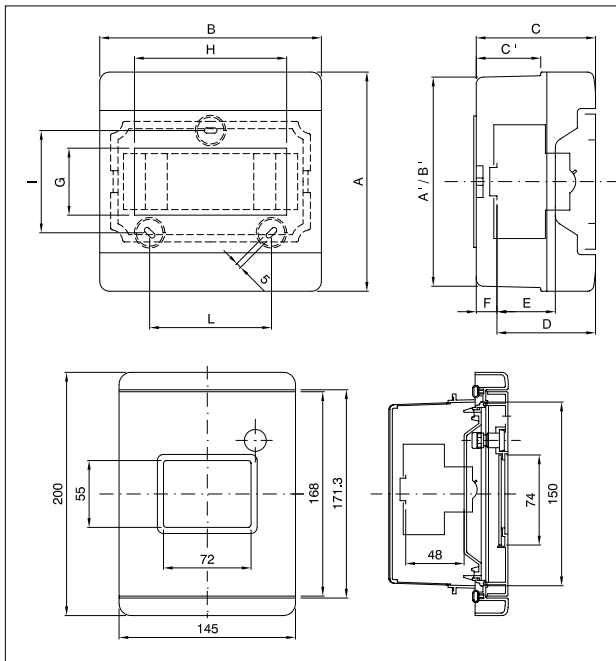
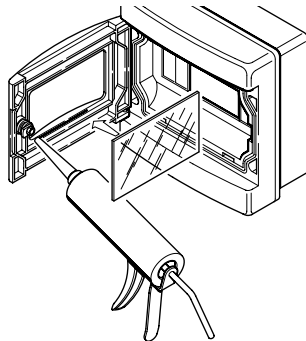

COD.	4M		8M	
	GW 42 204 GW 42 206 GW 42 207	GW 42 202 GW 42 208	GW 42 202 GW 42 208	GW 42 203
A	180	180	180	180
B	108	180	180	180
C	100	100	100	100
A'	172	172	172	172
B'	100	172	172	172
C'	55	55	55	55
D	75	75	-	-
E	48	48	-	-
F	12,8	12,8	-	-
G	55	55	55	55
H	55	125	125	125
NR	2	3	3	3
I	84	84	84	84
L	-	100	100	100

La sicurezza dell'apparecchio è garantita solo attenendosi alle istruzioni qui riportate. Pertanto è necessario leggerle e conservarle.
The safety of this appliance is only guaranteed if all the instructions given here are followed scrupulously. These should be read thoroughly and kept in a safe place.
 La sécurité de l'appareil n'est garantie que si l'on respecte les instructions mentionnées ci-joint. Il est donc nécessaire de les lire avec attention et de bien les conserver.
 La seguridad del aparato está garantizada sólo si se respetan las instrucciones aquí incluidas. Por lo tanto es necesario leerlas y conservarlas.
 Die Sicherheit des Geräts ist nur durch Einhalten der hier aufgeführten Anleitungen gewährleistet. Es ist daher notwendig, diese zu lesen und aufzubewahren.

SAT



035/946111
 8.30-12.30
 14.00-18.00



035/945222
 24h