



CODES	THB.400.A3EU THB.400.A4EU
Number of poles	3-4 Poles
Type of terminals	Screw
Contact marking	1-2-PE 1-2-3-PE
Current	41A
Voltage	690V AC
Impulse withstand voltage	6kV
Protection degree (IP6x)	IP66 / IP68 (5m-3h)
Conductor cross-section min. - max.	1.5 mm ² – 6.0 mm ²
Cable diameter min. – max.	15.0 mm – 21.0 mm
Conductor stripping length (mm)	12 mm
Cable sheath stripping length (mm)	30 mm
Raw materials of body / connector / sealing	PA6I GF40 / PA66 GFUL94 / NBR Halogen Free / Silicone Free
Ambient temperature min. – max.	-40°C / +125°C
Operating temperature Max.	+ 85°C
Reference regulations	EN 60998

SAFETY NOTES

- Disconnect the power supply before starting the assembly.
- To prevent dust and humidity / water from compromising the operation of the product, we recommended to use protective caps when the connectors are not connected (visit www.techno.it for more information).

ATTENTION



The connector has with live parts!

The connector is manufactured in compliance with electrical and safety regulations. It is the responsibility of those who assemble and install it to comply with the safety requirements of the system and ensure adequate protection from live parts.

NOTE



Read the assembly instructions carefully before assembly and installation!

The correct functioning of the product is guaranteed only if these assembly instructions are read and applied carefully.



Scan the QR code for more information.

Techno s.r.l.

Via Bancora e Rimoldi, 27 | 22070 Guanzate (CO), Italy | ph. +39 031 976445 | fax +39 031 976680
customer@techno.it | www.techno.it

INSTALLATION ILLUSTRATIONS

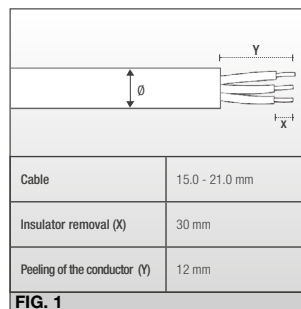

FIG. 1

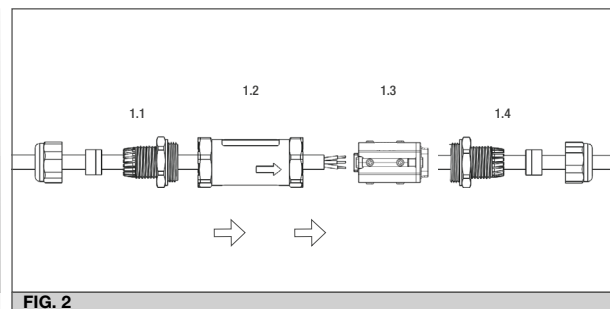

FIG. 2

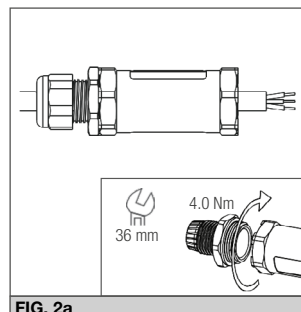

FIG. 2a



FIG. 3

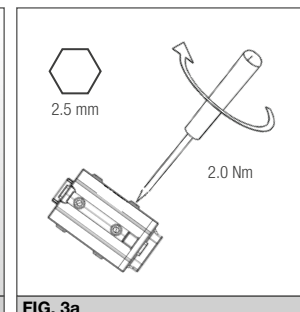

FIG. 3a

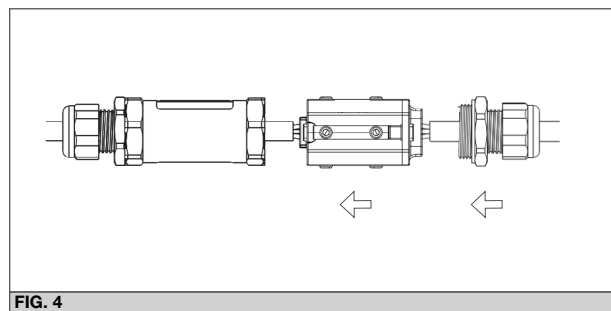

FIG. 4

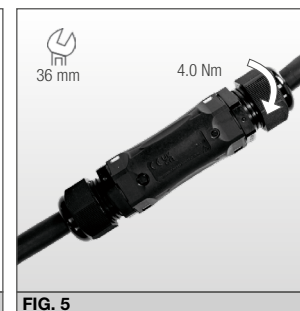

FIG. 5

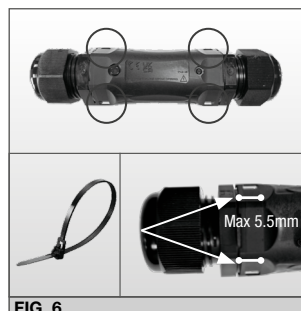

FIG. 6



FIG. 7

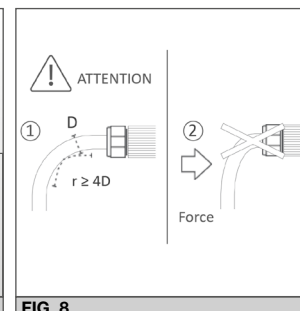

FIG. 8

INSTALLATION INSTRUCTIONS

FIG. 1

- Remove the insulation from the cable and conductors according to the specification indicated.

FIG. 2

- Insert the cable trough the pre-mounted cable gland (1.1) and the tube (1.2).
- On one side of the tube, tighten the cable gland clockwise using a common tool 36mm – 2.0 Nm (Fig.2a).

FIG. 3

- Insert each wire one by one into the terminals of the connector and tighten the screws of the wires clockwise, using a common hex screwdriver 2.5mm – 2.0Nm (Fig.3a).
- Make sure the wires/copper cores are properly inserted into the terminals, so they are in contact (⚠ example of incorrect installation).

FIG. 4

- Insert the previously worked cable (as indicated in Fig.1) trough the cable gland (1.4)
- Insert each wire one by one into the terminals in the opposite side of the connector. (as indicated in Fig.3a)
- Insert pre-cable connector into the tube, and tighten the cable gland (1.4) repeat the operation indicated in Fig. 2a.

FIG. 5

- Tighten the pre-mounted nut clockwise using a common tool 36 mm – 4.0Nm.

FIG. 6

- It is possible to fix the TH400U to a pole, using 2 commonly used cable ties, of max width 5.5mm.
- Simply insert the clamps into the appropriate slots positioned at the 2 ends of the tube.

FIG. 7

- Various accessories are available for the TH400U series: Adapter insert (code 6DB077400) for linear spring clamp.
- With a dedicated accessory it is possible to mount the TH460 cable gland on the TH400U tube (for further information contact us at customer@techno.it)

FIG. 8

- If the product is installed in tight spaces where it is necessary to bend the cable, pay attention to the minimum bending radius (1) that must be $\geq 4D$ (D= cable diameter).
- Make sure that the cable is not subject to external forces that tend to flex it. This phenomenon can affect the correct functioning of the product and above all jeopardize the resistance to dust and water infiltration.