

PROTECTION

AC disconnectable fuse holders

TECHNICAL DATA					
Fuse dimension:		8,5x31,5	10,3x38	14x51	22x58
Standard:		EN 60947-3	EN 60947-3	EN 60947-3	EN 60947-3
Rated current (In):	(A)	20	32	50	100
Rated operating voltage (Ue):	(V)	400 a.c.	690 a.c.	690 a.c.	690 a.c.
Rated insulation voltage (Ui):	(V)	400 a.c.	690 a.c.	690 a.c.	690 a.c.
Rated impulse withstand voltage (Uimp):	(kV)	8	8 4 (only for GW 96 220)	8	8
Category of use:		AC-22B	AC-22B	AC-22B	AC-21B
Rated conditional short-circuit current (Icc):	(kA)	50	200	100	100
Max power loss:	(W)	2,5	3	5	9,5
Degree of protection:		IP20	IP20	IP20	IP20
Operating temperature:	(°C)	-10...+40	-10...+40	-10...+40	-10...+40
Max cable section:	(mm ²)	25	25 10 (only for GW 96 220)	35	50

Circuit diagram

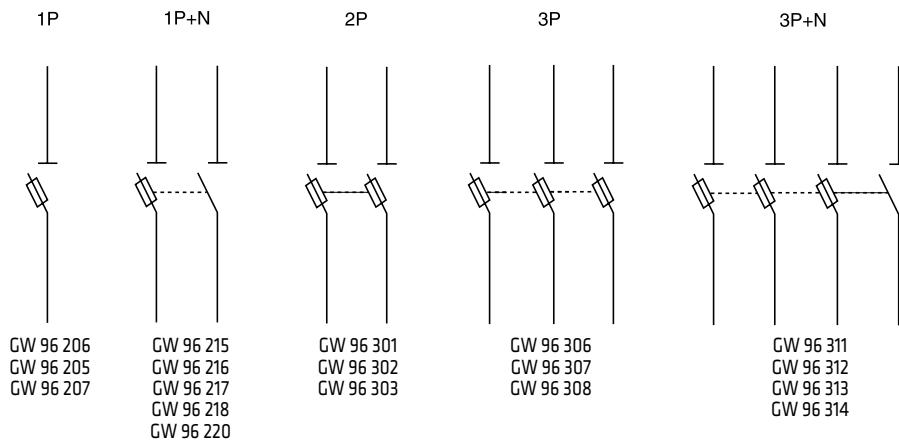

DC disconnectable fuse holders

TECHNICAL DATA	
Fuse dimension:	10,3x38
Standard:	EN 60947-3
Rated current (In):	(A) 20
Rated operating voltage (Ue):	(V) 1000 d.c.
Category of use:	DC-20B
Max power loss:	(W) 3
Max cable section:	(mm ²) 10

Circuit diagram

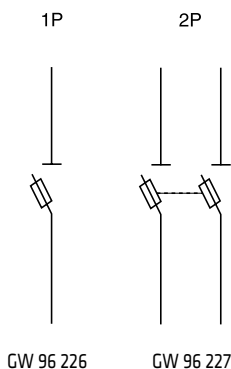

AC cylindrical fuses

TECHNICAL DATA					
Standard:	EN 60269-1, HD 60269-3				
Type:	gG				
Characteristic:	fast				
Dimensions:	(mm)	8,5x31,5	10,3x38	14x51	22x58
Rated current (In):	(A)	2÷25	2÷32	25÷50	63
Rated operating voltage (Ue):	(V AC)	400	400-500	400-500-690	690
Breaking capacity:	(kA)	50	120	80	80

Characteristic curves

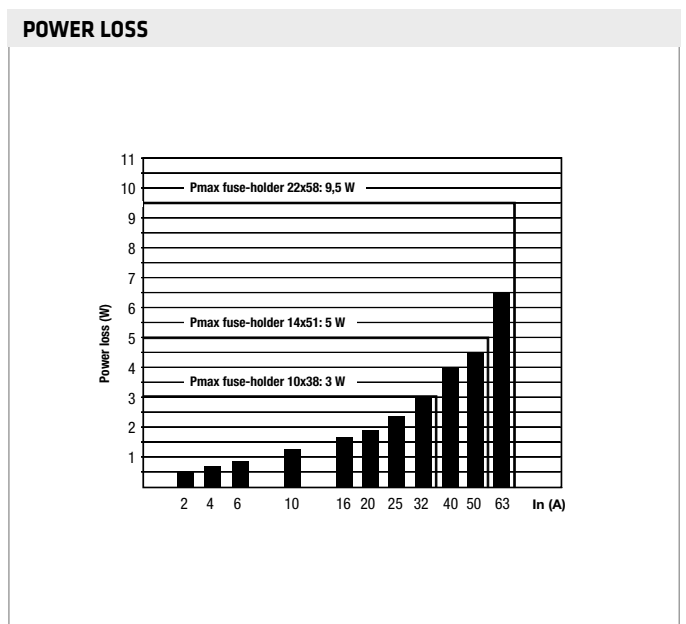
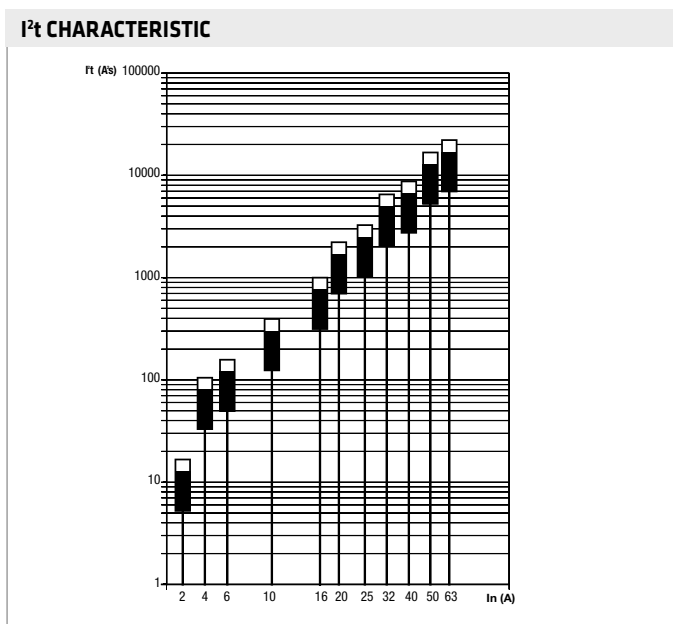
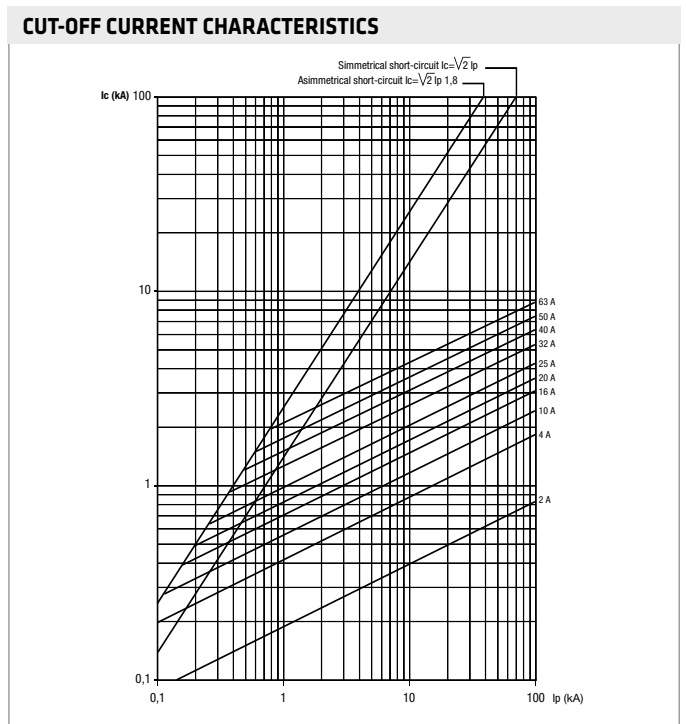
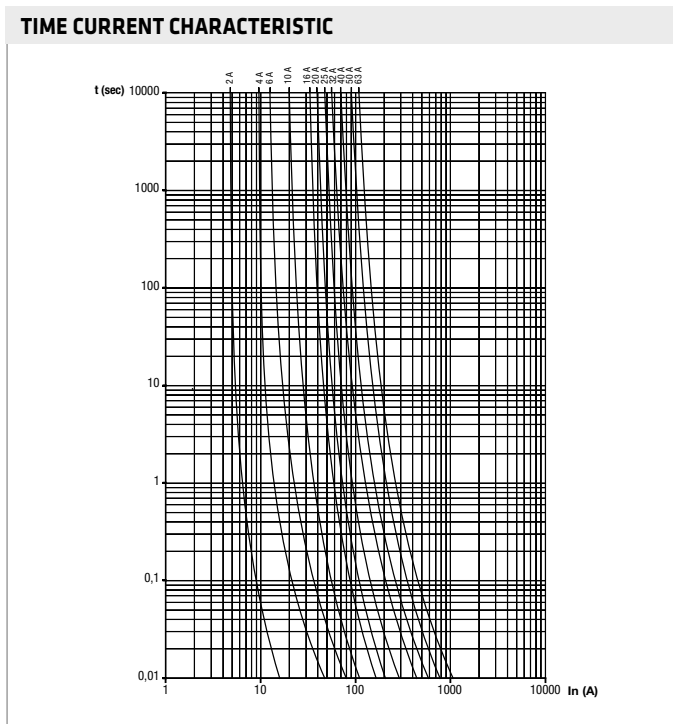

MODULAR ACCESSORIES

DC cylindrical fuses

TECHNICAL DATA							
Standard:		IEC 60269-4					
Type:		gPV					
Dimensions:	(mm)	10,3x38					
Rated operating voltage (Ue):	(V DC)	1000					
Breaking capacity:	(kA)	30					
Weight:	(g)	10					
Rated current (In):	(A)	6	8	10	12	16	20
Power loss at In:	(W)	1,65	1,9	2,3	2,4	2,5	3,25
Specific let-through energy at In:	(A ² s)	45	62	88	180	270	430

Characteristic curves

TIME CURRENT CHARACTERISTIC

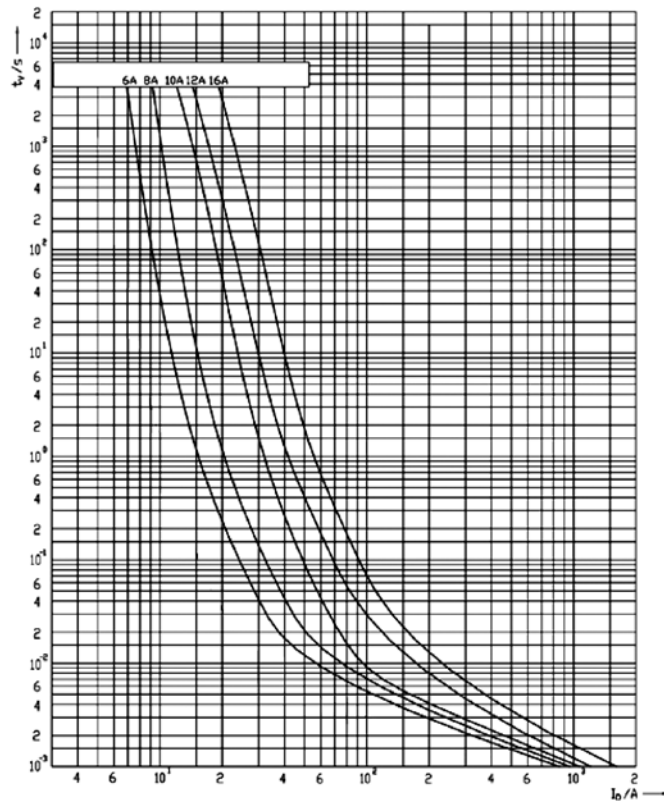

Dimension tables

AUXILIARY CONTACTS FOR MTC-MT-MTHP-MDC

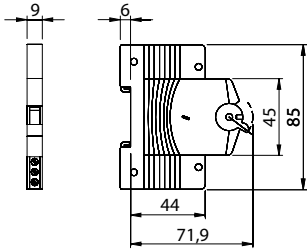

RELEASES FOR MTC-MT-MTHP-MDC

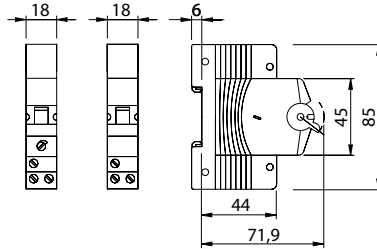

AUXILIARY CONTACTS AND RELEASES FOR SD

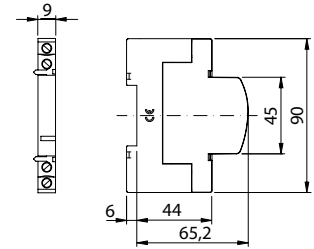

DISCONNECTABLE FUSE HOLDERS

AC Fuse holders

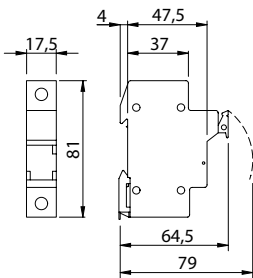

For fuses 8,5 x 31,5 - 10,3 x 38

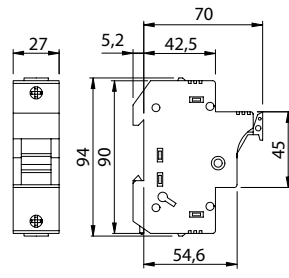

For fuses 14 x 51

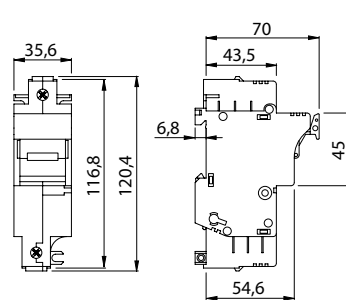

For fuses 22 x 58

DC Fuse holders

Compact fuse holder

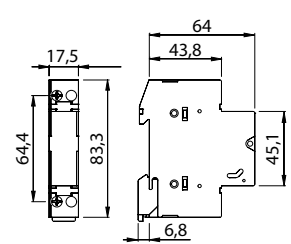

For fuses 10,3 x 38

MOTOR PROTECTION SWITCHES

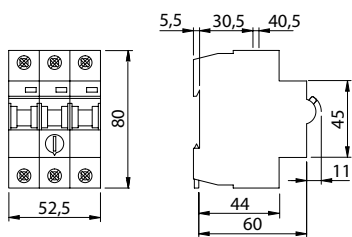

AC SWITCH DISCONNECTORS

