

Relè termico TOR-C

Thermal Overload Relay TOR-C

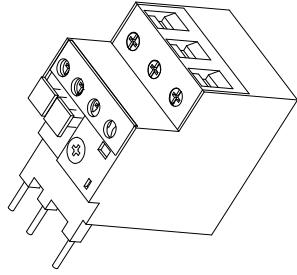

Disallmentare il dispositivo prima di ogni operazione.
Turn off the power before carrying out any repair or maintenance.

Assicurarsi di aver scelto il giusto relè termico in funzione della corrente di motore
Ensure that right thermal overload relay is selected due to the motor current

Tarare il relè termico alla corrente nominale del motore
Adjust the current setting selector of thermal overload relay according to full load current specified on the motor.

I relè termici usati con avviatori Y/D devono essere tarati alla $I_n \times 0,58$
Thermal overload relays used with Y/D starters are to be adjusted at $0,58 \times FLA$
Quando il relè scatta, il contatto (NO) 95-96 si apre, il contatto (NC) 97-98 si chiude
When relay trips, contact (NO) 95-96 opens and contact 97-98 closes

| | |
|---|-------------|
| Temperatura di funzionamento: Operational temperature: | -5° - 55° C |
| Temperatura di stoccaggio Storage temperature: | -40° - 70°C |

Montaggio

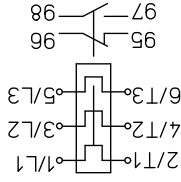
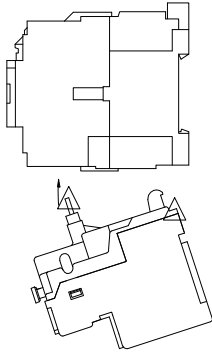
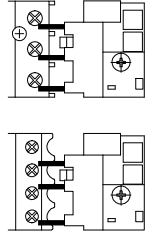

fig.1



Inserire i terminali di connessione come illustrato in fig.1
Insert connection pins as shown in fig.1

GHI5BN
GHI5CN
GHI5DN

GHI5ET
GHI5FT
GHI5GS

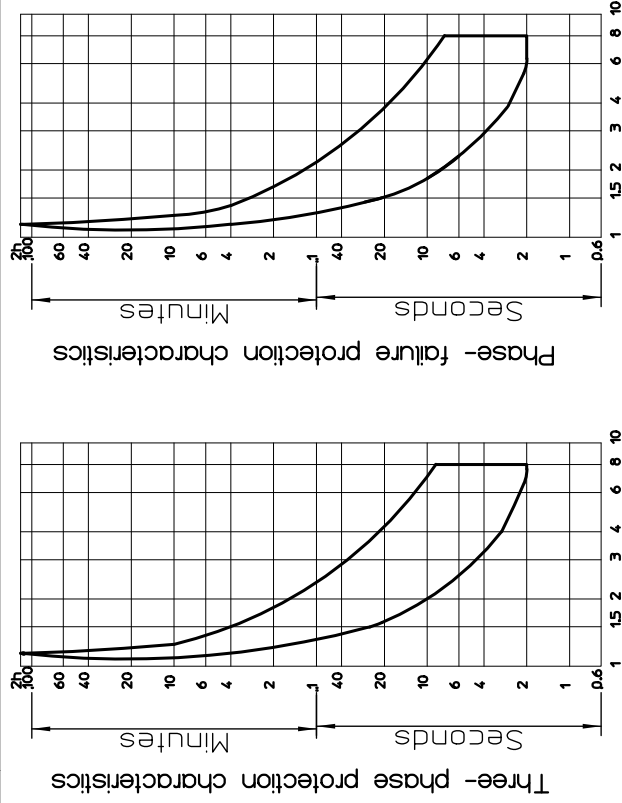

9306966 Oc107

| | | | | |
|--------------------|--------------------|-------------------|----------------|---------------|
| Trip Indicator | Reset Function | Stop Function | Contatti state | |
| | | | Aperto/Open | Chiuso/Closed |
| NC 95-96 | Aperto/Open | Chiuso/Closed | Aperto/Open | Aperto/Open |
| NO 97-98 | Chiuso/Closed | Aperto/Open | Aperto/Open | Aperto/Open |

Selezione del reset automatico
Setup of Auto-reset

- 1) Premere il pulsante di reset (R)
1) Push the reset button (R)
- 2) Spingere verso il basso la levetta
2) Pull-down the toggle

Dati tecnici

| | | | | |
|---|--|------|------|-------|
| Circuito principale / Main circuit | 690 Vac | | | |
| Tensione nominale di isolamento U_i Rated insulation voltage U_i | 690 Vac | | | |
| Circuito di controllo / Control circuit | 6 A | | | |
| Fusibile di protezione gG Short circuit protection fuse gG | 690 Vac | | | |
| Tensione nominale di isolamento U_i Rated insulation voltage U_i | 690 Vac | | | |
| | 24V | 230V | 400V | 125V |
| AC15 | 4A | 2A | 1.5A | DC-13 |
| | 2A | 1.5A | 2A | 0.55A |
| Circuito principale Main circuit | Contatti ausiliari Auxiliary contacts | | | |
| Sezione di collegamento Cable cross-section | 2 x 1...4mm ² AWG 18...12 | | | |
| | 2 x 1...4mm ² AWG 18...12 | | | |

Overall Dimensions :

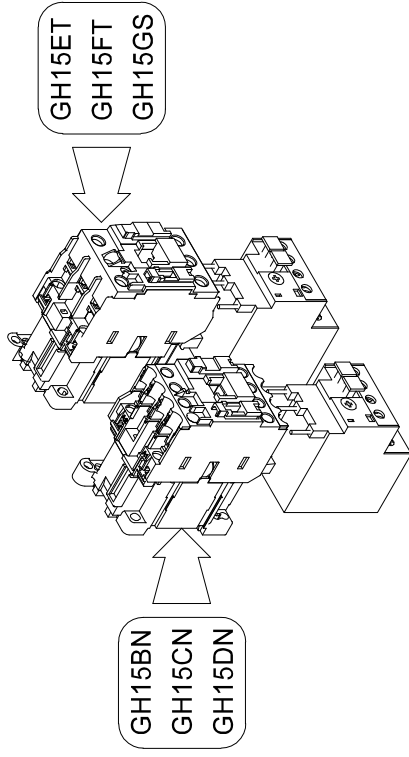
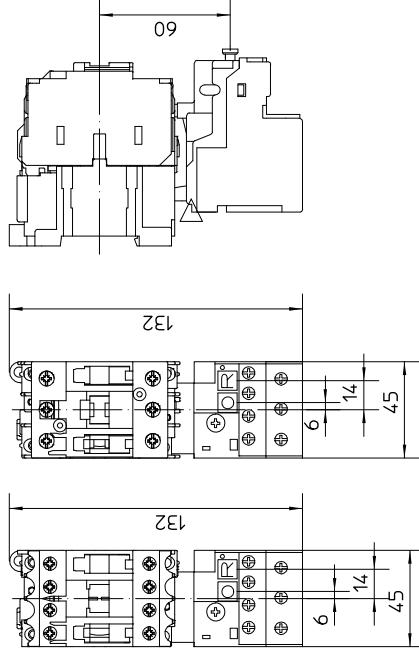

9306966 Oc107