

Mounting instructions for SM-DM kit

1) Drill the required holes for the base chosen (A o B)

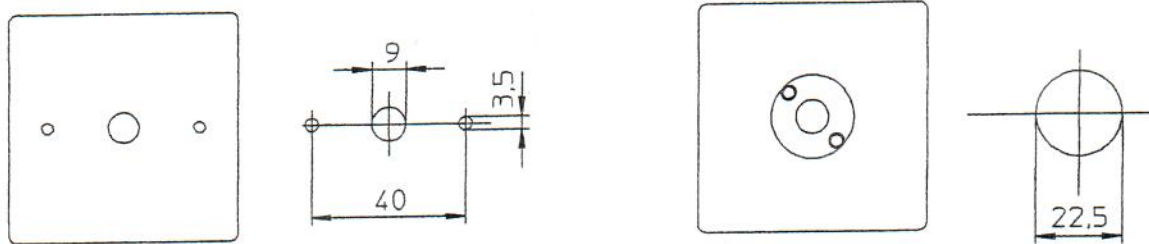

2) Fix the base plate and the SM-DM kit to the door, washer have been properly placed between door and base plate. (Fig.2)

3) Remove position indicator from the switch, press shaft (L=43mm) into the switch and connect the wires to the terminals. (Fig.3)

Fig.2

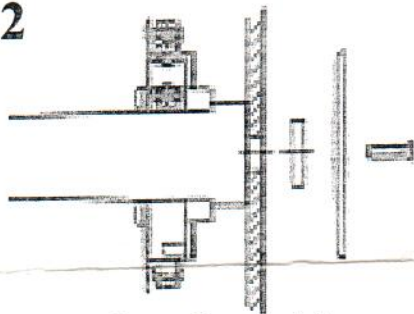
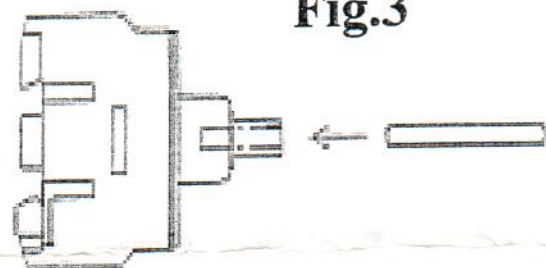

Fig.3



2) Turn switch to 0 position, push the switch in place until the snap-on grips are firmly clipped on both side of the switch.
Install the handle on the top of the base plate, washer have been properly placed between plate and handle. (Fig.4)

Fig.4

