

Accessories and complementary items for distribution and automation boards range 46.

| | | | |
|----------------------------|---------|-------------------------|--------------------|
| For boards LxH (mm) | 405x650 | Suitable for | 46QP - 46QM - 46QX |
| Type | Full | Type of material | Steel |
| Electrocod | 0303 | | |

DIMENSIONAL

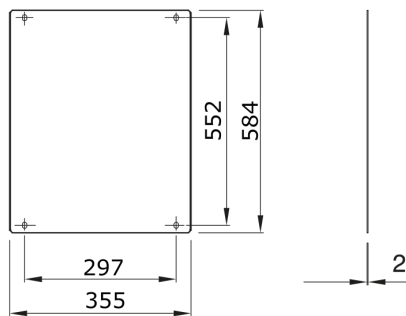

TECHNICAL SYMBOLOGY STANDARDS/APPROVALS



| | | |
|--|---|---|
| <p>GEWISS S.p.A. Via A. Volta, 1 24069 Cenate Sotto - Bergamo - Italy tel. +39 035 94 61 11 fax +39 035 94 69 09</p> | <p>www.gewiss.com sat@gewiss.com Last update 26/04/2018</p> | <p>Data, measures, designs and pictures are shown only as informativ purposes, and could be changed without previous notice</p> |
|--|---|---|