



GW 10 131

PUSH-BUTTONS 1P - 250V AC

Code	Description	Button key	Symbol	Pack Carton
No. Chorus modules: 1				
GW 10 131	1P NO - 16A	Neutral		12/96
GW 10 132	1P NO - 16A illuminable	With diffuser		12/24
GW 10 133	1P NO - 16A illuminable	With replaceable neutral lens		12/24
GW 10 136	1P NO - 16A	Pull-cord		1/12
GW 10 137	1P NC - 16A	Neutral	0 red	12/24
GW 10 138	1P NC+NO - 16 A	Stop	Red	12/24
GW 10 139	1P NO+NC - 16 A	Start	Green	12/24
GW 10 140	1P NO+NO - 10A	With interlock	UP - DOWN	12/24
GW 10 141	1P NO+NO - 16 A	Double		12/24
GW 10 142	1P NO - 16A illuminable	Green diffuser		12/24
GW 10 143	1P NO - 16A illuminable	Red diffuser		12/24
GW 10 144	1P NO - 16A illuminable	Opal diffuser		12/24
GW 10 151	1P NO - 16A illuminable	With replaceable neutral lens	Light	12/24
GW 10 152	1P NO - 16A illuminable	With replaceable neutral lens	Key	12/24
GW 10 153	1P NO - 16A illuminable	With replaceable neutral lens	Bell	12/24
No. Chorus modules: 1/2				
GW 10 161	1P NO - 10A	Neutral		6/24
GW 10 162	1P NO - 10A illuminable	With diffuser		6/24
No. Chorus modules: 2				
GW 10 171	1P NO - 16A	Neutral		6/24
GW 10 172	1P NO - 16A illuminable	With diffuser		6/24
GW 10 173	1P NO - 16A illuminable	With replaceable neutral lens		6/24
No. Chorus modules: 3				
GW 10 181	1P NO - 16A	Neutral		4/12
GW 10 182	1P NO - 16A illuminable	With diffuser		4/12
GW 10 183	1P NO - 16A illuminable	With replaceable neutral lens		4/12

CHARACTERISTICS: the illuminable articles use LED signalling units, not included.

GW10136 Cord in insulating material, 140cm long, with red knob.

GW10140 Button with mechanical interlock. Both contacts are open in the central position (OFF); advisable for activating motorised devices with direction reversal (e.g. roller-shutters, curtains, etc.).

GW10141 independent push-buttons that can also be activated simultaneously.



GW 10 134

PUSH-BUTTONS 2P - 250V AC

Code	Description	Button key	Symbol	Pack Carton
No. Chorus modules: 1				
GW 10 134	2P NO - 16A	Neutral	0	12/24
GW 10 135	2P NO - 10A illuminable	With replaceable neutral lens		12/24
GW 10 145	2P NO - 10A	With key		1/12

CHARACTERISTICS: the illuminable articles use LED signalling units, not included.

NOTES: GW10145 equipped with 2 keys. Spare keys: GW30912.



GW 10 191

PUSH-BUTTONS 1P WITH ILLUMINATED NAME PLATE - 250V AC

Code	Description	Lamp voltage	Lamp	Lamp power	Pack Carton
No. Chorus modules: 2					
GW 10 191	1P NO - 10A	12-24V ac/dc	Cartridge lamp S6x36 mm	2 W	6/24
No. Chorus modules: 3					
GW 10 192	1P NO - 10A	12-24V ac/dc	Cartridge lamp S6x36 mm	2 W	4/16

CHARACTERISTICS: lamp not included.

Chorus

THE SHAPES OF BEAUTY



ONE, GEO, LUX, ART, ICE and ICE Touch are the plates for the Gewiss CHORUS innovative domestic range: six different forms reflecting the character, personality and style of those who live in the home. With full spontaneity of gestures and the simplicity of the commands.

ALL THE BENEFITS OF A SINGLE FRAME



One single support (rectangular and square) compatible with all the plates of the Chorus range, without any need for additional adapters. The front coupling on the devices means quick, easy assembly and release without needing to remove the frame.

ERGONOMICS AND DESIGN



The wide range of component customisation possibilities, in terms of colour and modularity, guarantees a wealth of design and ergonomic solutions for every context. Four different colours, three different finishes: glossy white and ivory, satin black and painted titanium guarantee the perfect combination of component and plate.

DOMESTIC RANGES

General characteristics

TECHNICAL DATA AND REFERENCE STANDARDS								
Component	Reference standards	Essential electrical data*			Prolonged operation (no. of position changes)	Resistance to abnormal heat and fire		
		Resistance at test voltage (V)	Insulation resistance (MΩ)	Breaking capacity or category of use		Thermo-pressure with ball (°C)	Glow Wire Test (°C)	
Commands	EN 60669-1	2000 at 50 Hz for 1 minute	> 5	1.25 In (200 position changes)	40,000 at In 250V - cosφ = 0.6	125	850	
Italian Std. socket-outlets	IEC 60884-1			1.25 In (100 position changes)	10,000 at In 250V - cosφ = 0.8			
International Std. socket-outlets	IEC 60884-1			1.25 In (100 position changes)	10,000 at In 250V - cosφ = 0.8			
Latching relays	EN 60669-1 / EN 60669-2-2			40,000 at In 250V - cosφ = 0.6				
Momentary relays	EN 60669-1 / EN 60669-2-2			1.25 In (200 position changes)	3KA			8,000
Miniature circuit breakers	EN 60898-1			2** ± 5	3KA			4,000
Residual current circuit breakers	EN 61009-1 / EN 61008-1			-	-			-
Supports and plates	EN 60669-1	-	-	-	-	-	-	

* For rated voltages and currents, see the specifications for the individual codes. ** The value of 2 MΩ refers to a special condition established by the Standards given alongside.

Characteristics of screw terminals

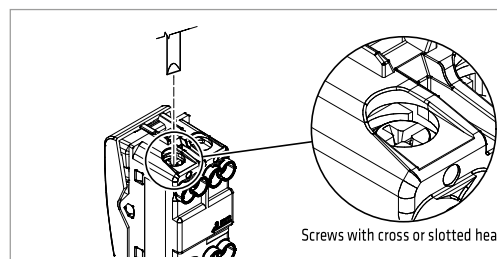

The terminals, located in the rear part of the devices, are manoeuvrable even after coupling the component to the support, and are suitable for both flexible and rigid cables. The components are supplied with the screws of the terminals open, to reduce wiring times.

TECHNICAL DATA			
Terminal grip on cable traction		>50N	
TERMINAL TIGHTENING CAPACITY			
Stranded wires		Solid wires	
Minimum 0.75 mm ²	Maximum 2x4 mm ²	Minimum 0.5 mm ²	Maximum 2x2.5 mm ²

Characteristics of spring terminals (quick wiring)

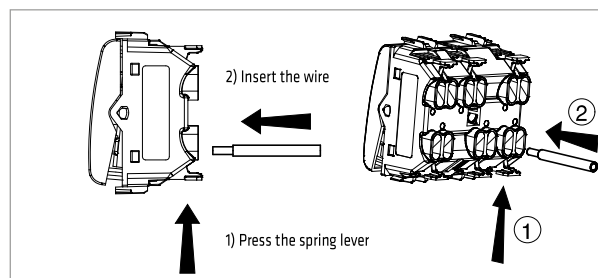

The spring terminals allow you to carry out the wiring in a shorter time, and without using screwdrivers or other tools. To insert the cable, it is necessary to press the orange lever (opening of terminal). Releasing the lever, the terminal closes automatically, firmly blocking the cable.

TECHNICAL DATA			
Terminal grip on cable traction		>50N	
TERMINAL TIGHTENING CAPACITY			
Stranded wires		Solid wires	
Minimum 0.75 mm ²	Maximum 2x4 mm ²	Minimum 0.5 mm ²	Maximum 2x2.5 mm ²